

**Roth panel system PS20,
EPS 30/10, EPS 50/30**
Installation

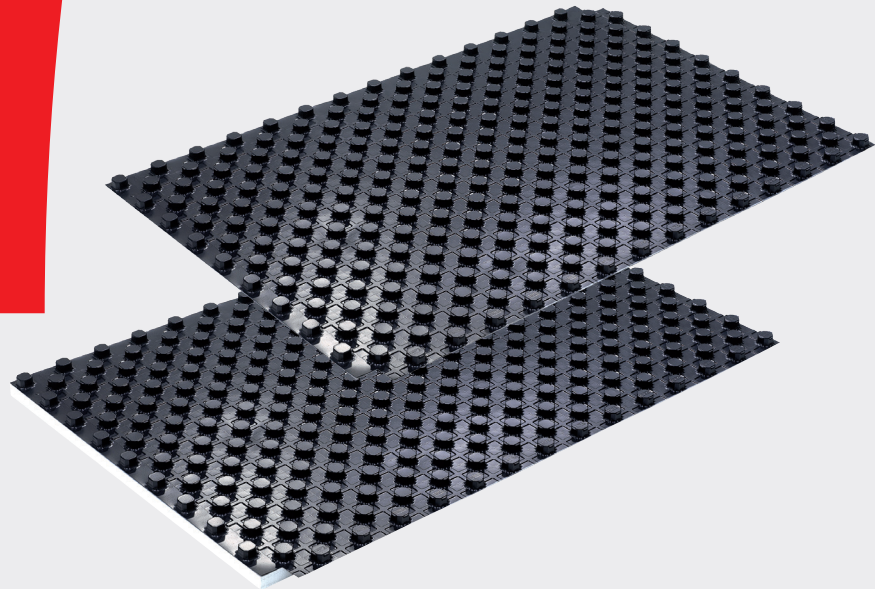

German quality since 1947

Roth panel system PS20, EPS 30/10, EPS 50/30

Description

Roth panel system PS20, EPS 30/10 and EPS 50/30 can be used both for new construction and renovation tasks where concrete floors with embedded underfloor heating pipes are used. The panel system is supplied in full panel format as 1.450 x 950 x 20, 30 or 50 mm, covering areas ranging from 10 m² to 16.4 m² and 20.1 m², making the product very light but also easy to handle on construction sites.

The Roth panel system PS20, EPS 30/10 is a panel system designed for constructions where concrete is to be poured over the underfloor heating pipes. The Roth panel system PS20, EPS 30/10 can be laid directly on a load-carrying concrete floor or on EPS insulation or hard mineral wool suitable for encasing in poured concrete.

After laying out the panels, the connectors are linked, including the overlap/connection on the panel. Or, if necessary, Roth connectors are used to connect to system panels so that the concrete stays on top of the panels. With this system it is extremely important to use Roth edge insulation with 160 mm PE film. The PE film is made so that it can lie in the outermost groove with the pipe and create a seal against the concrete flowing underneath the system. Traditional concrete can be used, or you can choose to use a fibre-reinforced liquid screed which must of course completely cover the panels.

Important!

If you use the underfloor heating to dry the concrete, do this at a low flow temperature, typically 5 degrees higher than the concrete temperature. Always ask the concrete supplier before starting the drying process.

In larger buildings such as warehouses and industrial buildings, floors are divided into smaller areas and this is done using expansion joints.

The places where the underfloor heating pipes cross the joints must be protected against the movements of the concrete surfaces; this can be achieved using a piece of Roth piping.

Pay attention to the stricter requirements for insulation when there is underfloor heating in the ground floor and comply fully with the applicable BR and other rules.

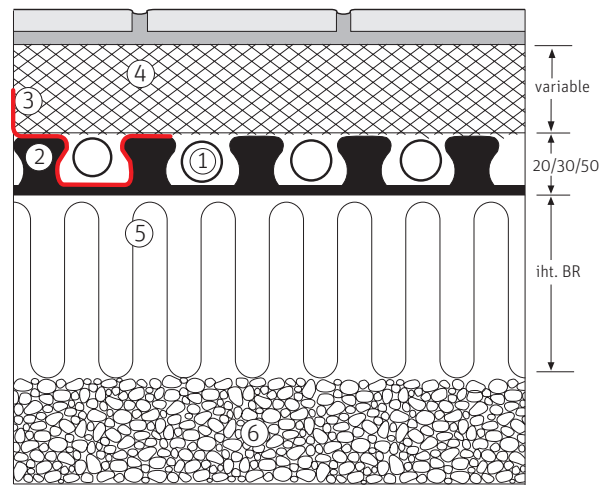

1. Roth underfloor heating pipes
2. Roth panel system PS20, EPS 30/10, EPS 50/30
3. Edge insulation/PE film
4. Concrete/Screed (EN 13813) as Roth Clima Comfort Flow
5. Insulation as per legal requirements
6. Sub-floor

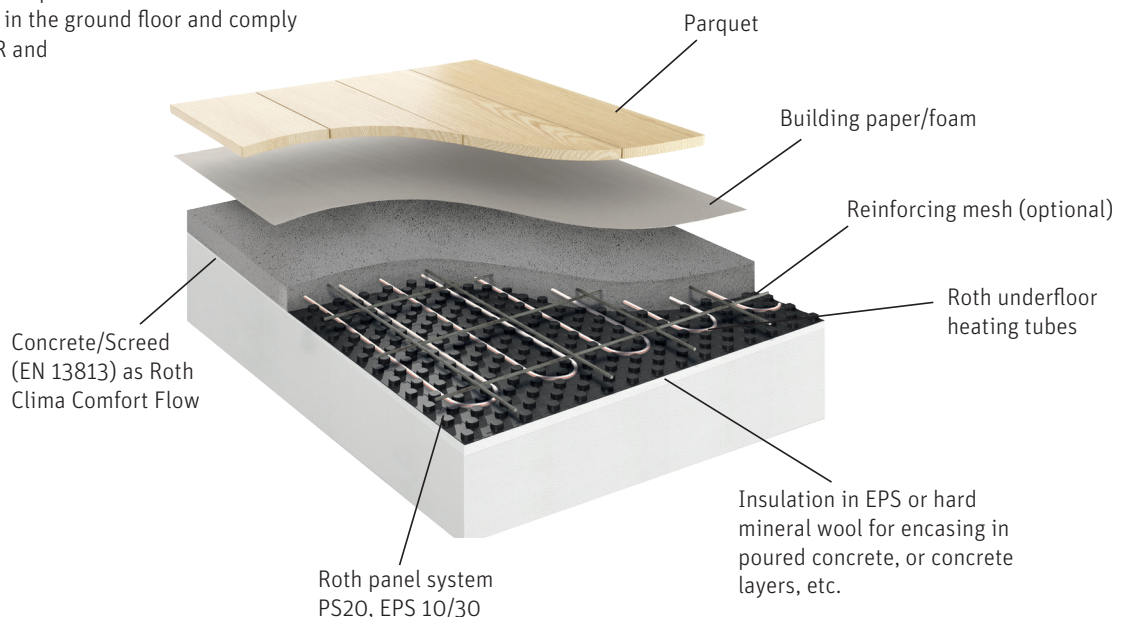

Roth panel system PS20, EPS 30/10, EPS 50/30

1. Start by laying Roth edge insulation along all walls in the rooms where underfloor heating is to be installed with Roth panel system PS20, EPS 30/10. The edge insulation must be fitted neatly and close to the wall and the plastic PE film must be accessible and left free.

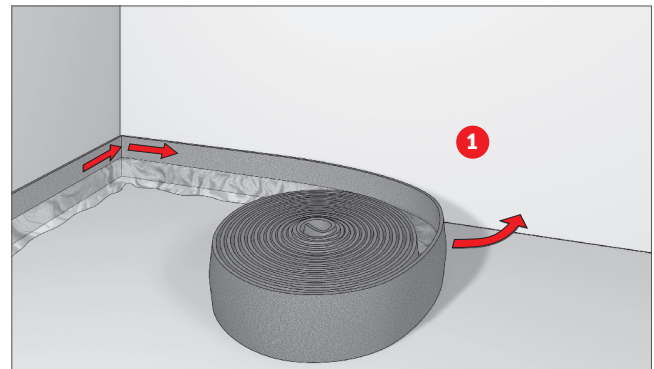

2. Roth panel system plate PS20, EPS 30/10 is laid out on concrete or insulation material from wall to wall. After laying out the panels, the connectors are gathered together with a self-adhesive overlap so that the concrete stays on top of the plates. Roth panel system PS20, EPS 30/10 can be cut to size using a sharp knife blade; note that the overlap assembly must not be removed.

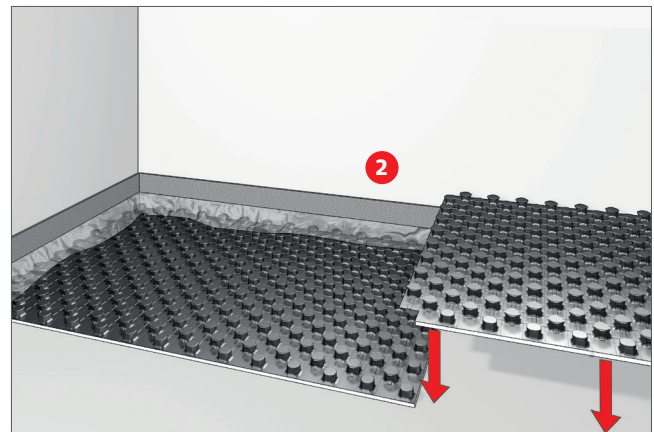
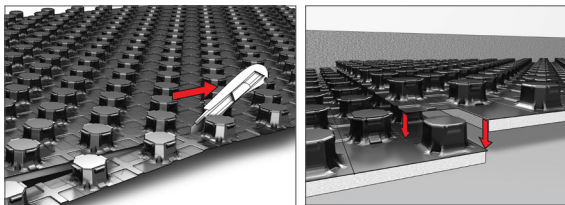

3 + 4. The underfloor heating pipes can now be fitted. The central spacing of the underfloor heating pipes depends on the dimensioned heating requirement in the room concerned and the concrete thickness above the heating pipes.

It is important that pipes and PE film are assembled correctly alongside the outer wall, so that the plate system does not rise when the concrete floor is poured. The PE film is laid out on the panels and then the tube is passed over the PE film to seal the connection.

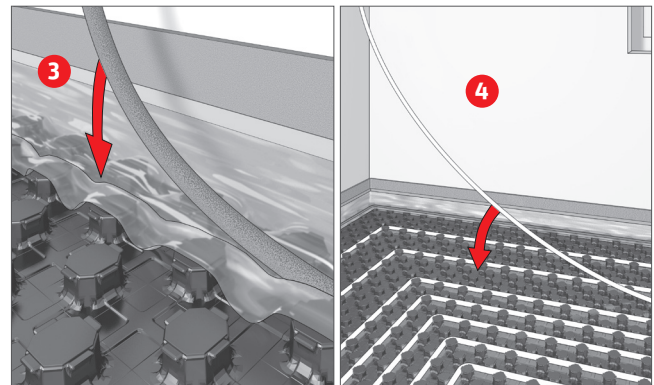

5. The piping can be completed by connecting the underfloor heating pipe to a Roth GV distribution box. You can optionally choose whether the installation should be installed in a wall or as a free-standing installation.

NB! The underfloor heating pipes must always be pressure-tested in accordance with applicable legislation.

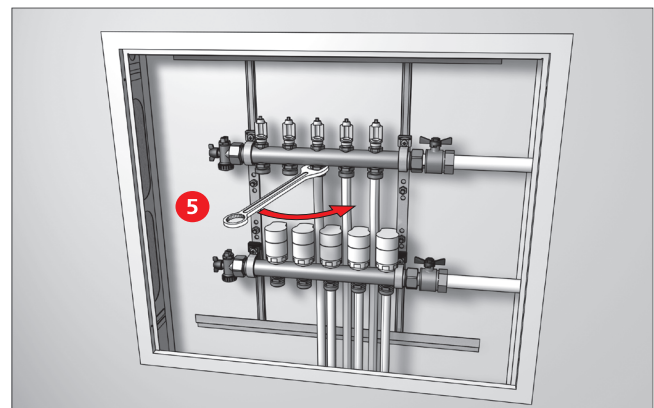

Roth panel system PS20, EPS 30/10, EPS 50/30

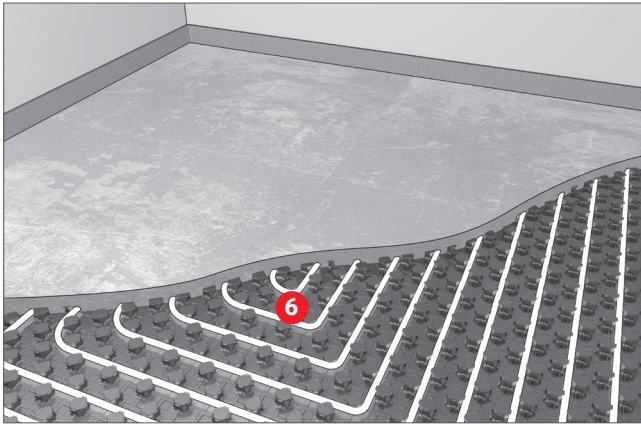

6. Concrete casting can now be carried out. In certain cases there may be a need/requirement for the installation of reinforcement mesh before casting begins.

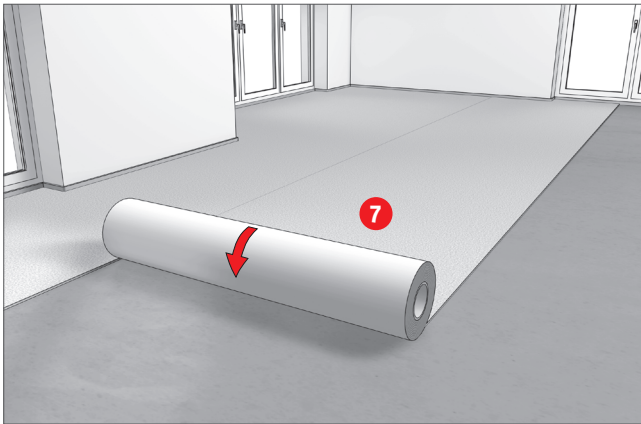

7. The floor heating system is now installed and the concrete layer is cast; you can now begin to lay your floor.

NB! Special attention should be paid to the drying time of the concrete. This is something that should be clarified before laying foam/building paper with wooden flooring as it may damage the structure.

Technical data

Roth panel system PS 20/0	UK No. 1135006031
Roth panel system EPS 30/10	UK No. 1115007914
Roth panel system EPS 50/30	UK No. 1115007913
Roth connector for panel system	UK No. 7339298920
Roth pipe fastener, diagonal	UK No. 7339298910
Roth Clima Comfort edge insulation 160 mm, 25 m	UK No. 7339259030

Roth

ROTH UK Ltd (Head office and warehouse)

1a Berekeley Business Park
Wainwright Road
Worcester
WR4 9FA
Phone +44 (0) 1905 453424
E-Mail sales@roth-uk.com
E-Mail technical@roth-uk.com
www.roth-uk.com